

1 SECTION  
剖面圖 SCALE 1:5

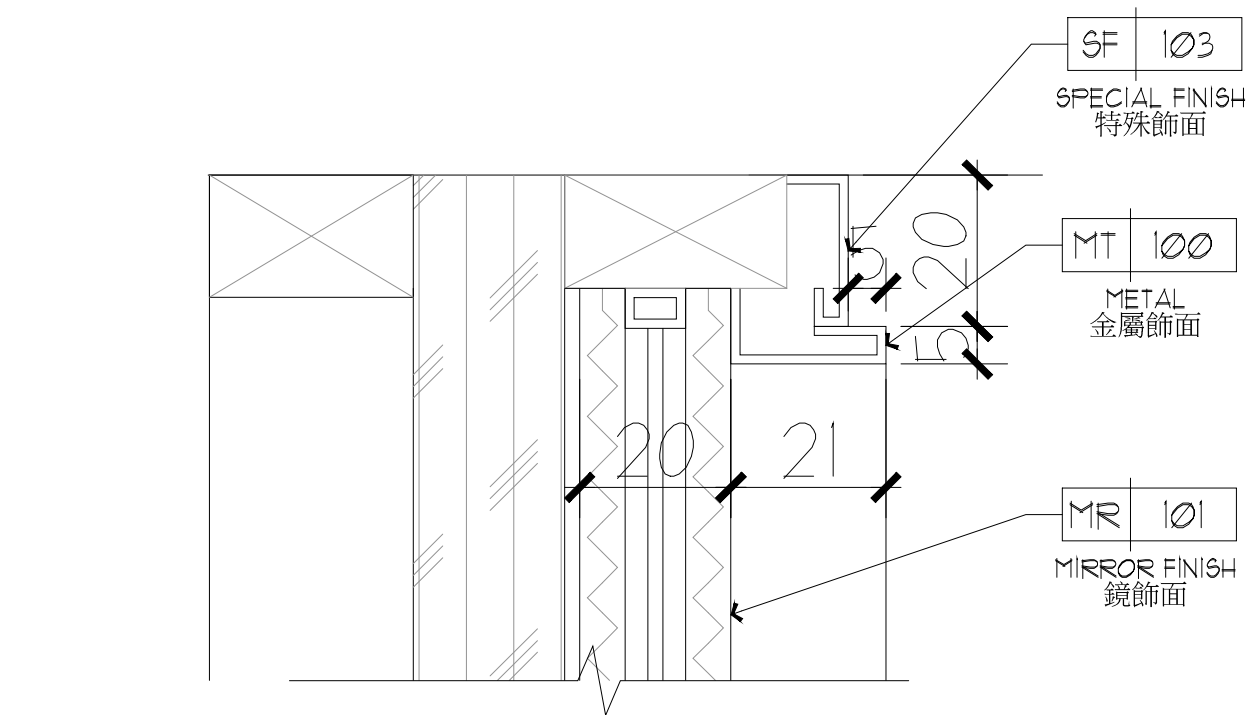

2 DETAIL  
大樣圖 SCALE 1:2

FOR TENDER  
DATE: 15 MAR 2016

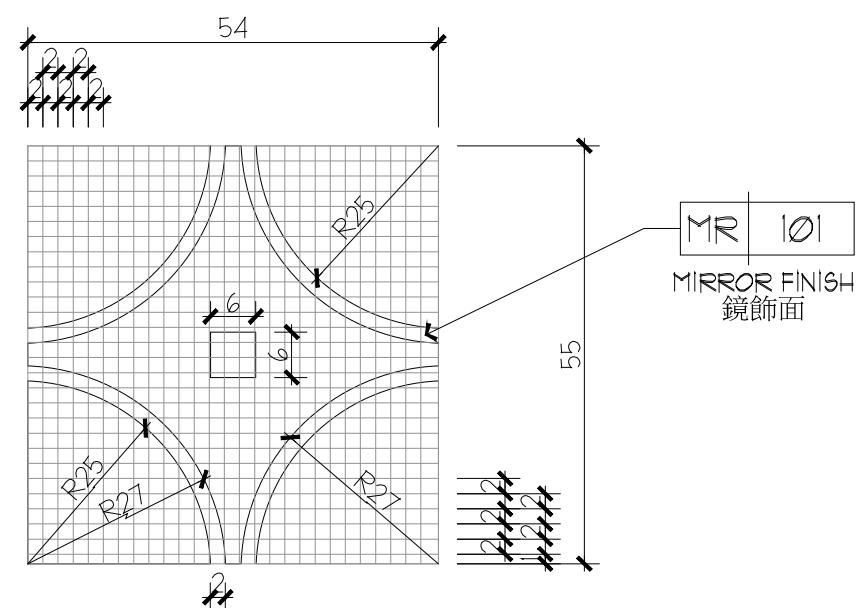

3 DETAIL  
大樣圖 SCALE 1:2

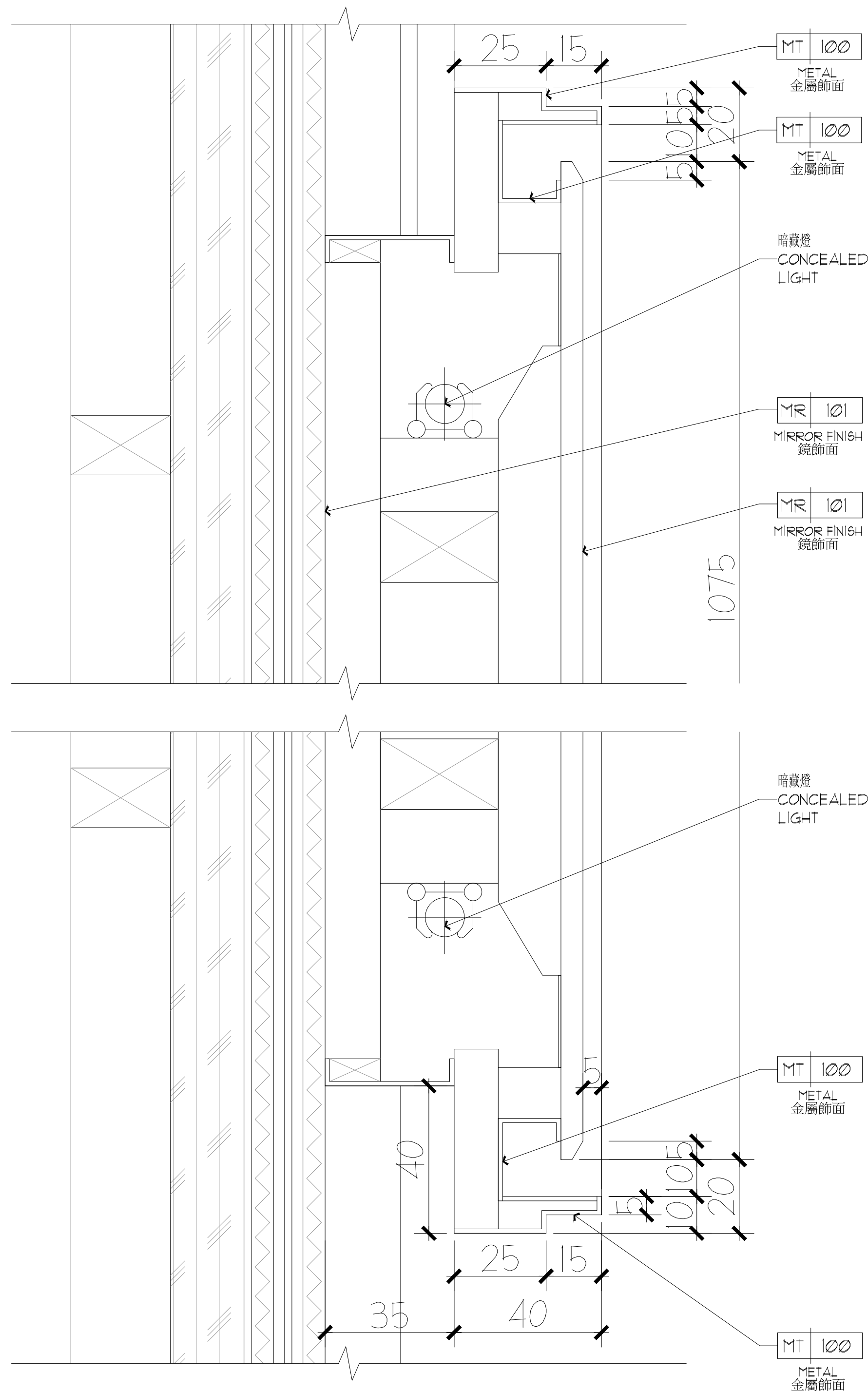

4 DETAIL  
大樣圖 SCALE 1:2

仰光泛太平洋酒店  
PAN PACIFIC  
YANGON, MYANMAR

REVISION	DATE
1	17 JUL, 2015
2	14 SEP, 2015
3	16 MAR, 2016

CLIENT 建設單位

ALL DESIGNS AND SPECIFICATIONS ARE THE PROPERTY OF CHENG CHUNG DESIGN (HK) LTD. AND CANNOT BE USED WITHOUT THEIR WRITTEN PERMISSION. THE SAME SHALL BE RETURNED UPON COMPLETION OF THE PROJECT. DO NOT SCALE DRAWINGS. ALL MEASUREMENTS MUST BE CHECKED ON SITE BY THE CONTRACTORS AND ANY DISCREPANCIES BROUGHT TO THE ATTENTION OF THE DESIGNER OR ARCHITECT. THIS DRAWING IS TO BE USED FOR THE PROJECT AND SITE IDENTIFIED AND NOT TO BE USED ON ANY OTHER PROJECT.

CCD  
ChengChung Design  
香港鄭中設計事務所

CHENGCHUNG DESIGN (HK) LTD.  
27F, CNT TOWER, NO. 338 HENNESSY ROAD  
WAN CHAI, HONG KONG  
TEL. NO. +852-2548-2009 FAX. NO. +852-2548-2089  
E-MAIL: DESIGN@CCD.COM.HK  
DRAWING TITLE 圖名

GUESTROOM AREA - 客房部份  
L7M MOCK UP ROOM - 七夾層樣板房  
DELUXE KING - 標準大床房  
VANITY DETAILS - 洗手盤大樣圖

DESIGN NO. 設計編號:	HK-1410
PROJECT DIRECTOR 設計總負責人	PH
DESIGNED BY 設計	DRAWN BY 繪圖
PH	PH
PROCESSED BY 審核人	PH
CHECKED BY 校對人	APPROVED BY 核准
PH	BK/UB
DISCIPLINE 專業	STATUS 階段
INTERIOR DESIGN	TENDER
SCALE 比例	DATE 日期
AS SHOWN @ A1	03 JUL, 2015
SHEET NO. 圖號	

DT-1.7-02